

ORBINOX

VALVE SOLUTIONS IN MORE THAN 70 COUNTRIES

Valves for
pulp & paper





Valves for pulp & paper



ORBINOX was founded in Tolosa (northern Spain) during the late 60's as a manufacturer of knife gate valves servicing the local pulp and paper industry. Recognizing that success is built on understanding customers' processes and by finding innovative solutions for difficult applications, we focused on increasing our engineering capabilities and developed many engineered valves for diverse industrial sectors. In the late 70's the company introduced the knife gate valve line in North America and other parts of the world. Today we have manufacturing plants in Spain, Canada, China,

India, UK and Brazil, sales and distribution centers in Spain, UK, Germany, France, Canada, USA, Brazil, China, India and South East Asia; and a network of agents worldwide.

ORBINOX offers a wide range of knife gate valves for handling diverse applications in the pulp & paper, water, wastewater, bulk handling and other process industries. With more than 45 years experience in the industrial market worldwide, and has become a well-known innovative knife gate manufacturer responding to new industrial developments.





EX EK

Unidirectional semi-lugged knife gate valves for general service, assure non-clogging shut off with suspended solids. Fully modular design, available in multiple configurations and sizes, including high-alloy steels.

The **EK** valve is the high performance version. Its cast retainer ring system (K type) improves tightness and simplifies maintenance operations.

Reliable for pulp concentrations up to 5%

Sizes: DN 50 to DN 1200

Working pressure: DN 50 - DN 250 (10 bar)
 DN 300 - DN 400 (6 bar)
 DN 450 (5 bar)
 DN 500 - DN 600 (4 bar)
 DN 700 - DN 1200 (2 bar)

Flange drilling: PN10, ANSI 150 (Other on request)



ET

Heavy duty unidirectional lugged knife gate valve for general service designed according to MSS-SP-81 and TAPPI TIS 405-8, assures non-clogging shut off with suspended solids.

Fully modular design, available in multiple configurations and sizes.

Reliable for pulp concentrations up to 5%

Sizes: DN 50 to DN 900

Working pressure: DN 50 - DN 600 (10 bar)
 DN 750 (7 bar)
 DN 900 (7 bar)

Flange drilling: PN10, ANSI 150 (Other on request)

EB BT



Bi-directional knife gate valves with perimeter seal removing grooves that can collect pulp and prevent the valve from operating properly. Its unique full-bore design with no cavities in the seating area gives excellent flow characteristics and avoids clogging. One or two piece valve body depending on valve size.

Reliable for pulp concentrations up to 8%-10%

Sizes: DN 50 to DN 1200

Working pressure: DN 50 - DN 250 (10 bar)
DN 300 - DN 400 (6 bar)
DN 450 (5 bar)
DN 500 - DN 600 (4 bar)
DN 700 - DN 1200 (2 bar)

The **BT** valve is the heavy duty lugged version designed according to MSS-SP-81 and TAPPI TIS 405-8.

Sizes: DN 50 to DN 600

Working pressure: DN 50 - DN 600 (10 bar)

Flange drilling: PN10, ANSI 150 (Other on request)

TL/TK TH



Bi-directional through conduit knife gate valves for high pulp concentrations and other demanding applications. All versions have a two piece valve body with internal sliders for a smooth gate travel. Fully modular design, available in multiple configurations and sizes, including high-alloy steels.

The **TK** valve is the high performance version. Its cast retainer ring system (K type) improves tightness and simplifies maintenance operations.

Reliable for pulp concentrations up to 18%

Sizes: DN 50 to DN 1000

Working pressure: DN 50 - DN 125 (10 bar)
DN 150 - DN 250 (8 bar)
DN 300 - DN 400 (6 bar)
DN 450 (5 bar)
DN 500 - DN 600 (4 bar)
DN 700 - DN 1000 (2 bar)

The **TH** valve is the heavy duty version suitable for high pressure.

Sizes: DN 300 to DN 1000

Working pressure: DN 300 - DN 800 (10 bar)
DN 900 - DN 1000 (6 bar)

Flange drilling: PN10, ANSI 150 (Other on request)



CR CK

Knife gate valves suitable for reject handling in recycling applications, like junk or sand traps, cleaners, etc.

The **CR** valve has a two piece body with round inlet and square outlet (larger than the inlet) ensuring non-jamming operation. Available in multiple configurations and sizes, such as gate surface treatments or double gland systems.

Sizes: DN 100 to DN 600

Working pressure: DN 100 - DN 400 (7 bar)
DN 500 - DN 600 (4 bar)

The **CK** valve is the fabricated square inlet and outlet version (larger than the inlet), particularly used as bottom valve in Junk Trap systems.

Flange drilling: PN10, ANSI 150 (Other on request)



DT

Double gate bi-directional knife gate valve suitable for handling highly concentrated or contaminated media in recycling applications.

The two piece body with its fully lined low friction interior and double gate design offers extremely fast opening and closing times.

Sizes: DN 100 to DN 600

Working pressure: DN 100 - DN 250 (10 bar)
DN 300 - DN 400 (6 bar)
DN 450 (5 bar)
DN 500 - DN 600 (4 bar)

Flange drilling: PN10, ANSI 150 (Other on request)

JUNK TRAP

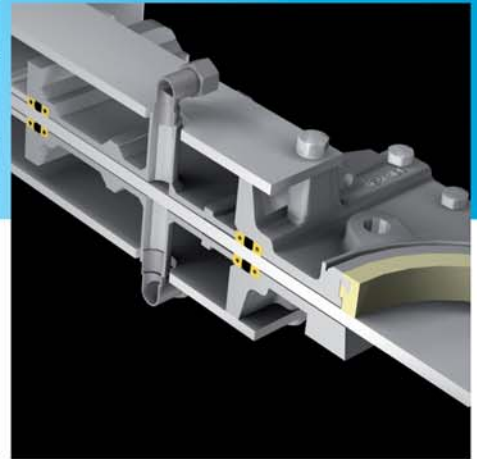

Junk trap

The ORBINOX junk trap provides a system to handle reject impurities in pulp and paper applications.

The usual configuration is a **CR** valve as inlet and a **CK** valve as discharge valve with a square and conic shape reject tank between the valves. The tank design and the inclined position of the discharge valve minimize wear.

The valves can be supplied in multiple configurations, such as gate surface treatments, vortex breaker seats or double gland systems.

Other valve types can be also used according to customer's choice (i.e. EK, ET, TL/TK as inlet and CR or TL/TK as outlet).

Please contact your Orbinox representative for further information.

Double packing

For the toughest service conditions this option ensures high cycle packing performance avoiding leakage as a result of gate wear caused by impurities.

CR Seating options

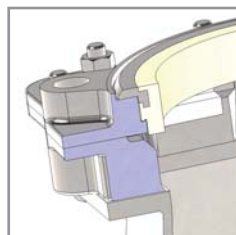

Polyurethane

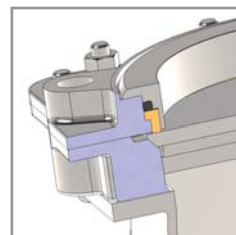

Bronze

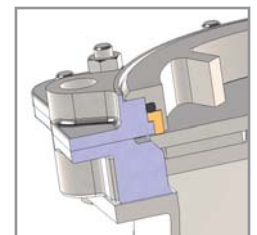

Bronze + Vortex breaker

Other valves



RM

Tilting disc valve



TP

Sampling valve



KP

Transmitter
isolation valve

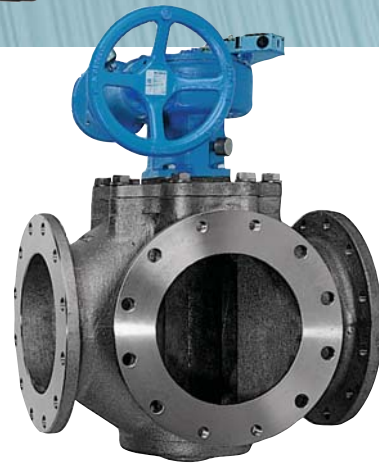

3/4 V

3/4 way valve

Seating options

EX/ET

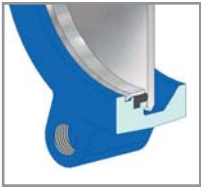

Resilient A type
(standard)

EK



Resilient K type

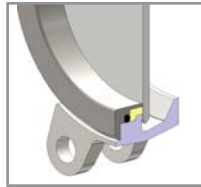

PTFE K type

TL

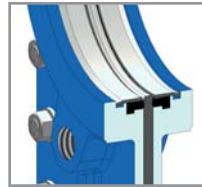

Resilient A type

EB

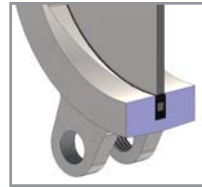

Resilient seat

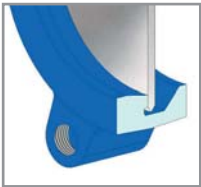

Metal to metal



Metal to Metal
K type



Polyurethane
K type

TK

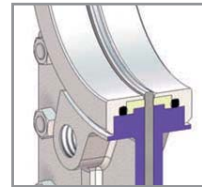

Resilient K type

BT



Resilient seat

Actuator types



Bevel gear



Handwheel
non-rising
stem



Handwheel
rising stem



Pneumatic
cylinder



Electric
actuator



Single acting
cylinder



Hydraulic
cylinder



Chainwheel



Lever



ORBINOX

VALVE SOLUTIONS IN MORE THAN 70 COUNTRIES

MEMBER OF THE **AVR** GROUP

ORBINOX VALVES INTERNATIONAL

Parque Tecnológico de San Sebastián
Pº Mikeletegi, 56-planta 3º
20009 DONOSTIA-SAN SEBASTIÁN-SPAIN
Tel.: +34 943 69 80 30
Fax: +34 943 30 92 83
e-mail: ovi@orbinox.com

ORBINOX S.A.

Políg. Industrial s/n
20270 ANOETA - SPAIN
Tel.: +34 943 69 80 30
Fax: +34 943 65 30 66
e-mail: orbinox@orbinox.com

ORBINOX, UK

Units 6-7 Clock Park
Shripney Road - Bognor Regis
WEST SUSSEX- PO22 9NH
Tel. +44 (0) 1243 810240
Fax. +44 (0) 1243 870040
e-mail: uk@orbinox.com

ORBINOX, INDIA

608/3A-2B, 608/3A-1B,
Eachanari - Chettipalayam Road,
Eachanari Post, 641021 COIMBATORE
Tel. +91 422 6691261
Fax +91 422 6691106
e-mail: india@orbinox.com

ORBINOX S.E.A.

Jl. Pilar Raya No.47, Kedoya Selatan
Jakarta Barat 11520, INDONESIA
Tel: +62 21 5835 8866
Fax: +62 21 5835 8668
e-mail: orbinox.sea@orbinox.com

ORBINOX COMERCIAL

Políg. Industrial Beotibar s/n
20491 BELAUNZA - SPAIN
Tel.: +34 943 69 80 33
Fax: +34 943 65 30 22
e-mail: comercial@orbinox.com

ORBINOX, GERMANY

Kurzer Morgen 3
D - 58239 SCHWERTE
Tel. +49 230 49 57 05 70
Fax +49 230 49 57 05 79
e-mail: germany@orbinox.com

ORBINOX, FRANCE

22, Rue Jean Rostand
69740 GENAS
Tel. +33 478 04 01 25
Fax. +33 478 04 03 56
e-mail: france@orbinox.com

ORBINOX, CHINA

Room I, Floor 21,
ZhaoFeng Universal Building
No.1800, Zhongshan West Rd.
Xuhui District, Shanghai 200233, CHINA
Tel: +86(21)64400828 / +86(21)64400508
Fax: +86(21)64400865
e-mail: china.sales@orbinox.com

ORBINOX, CANADA

2050 Dagenais Blvd. West
LAVAL, QUEBEC H7L 5W2
Tel. +1 450 622 87 75
Fax +1 450 622 68 31
e-mail: canada@orbinox.com

ORBINOX, USA

311 North Front Street
AMORY, MISSISSIPPI 38821
Tel. +1 662 256 2227
Fax +1 662 256 2119
e-mail: usa@orbinox.com

ORBINOX, BRAZIL

Rua Alberto Magnusson, n° 162
13.347-663 Vitória Martini
INDAIATUBA, SÃO PAULO
Tel. + 55 (19) 3935-5369
e-mail: brasil@orbinox.com

DAMPER TECHNOLOGY LTD

Meadowbank House,
Meadowbank Court, Eastwood,
Nottingham-NG16 3SL-ENGLAND
Tel. +44 115 9324046
Fax: +44 115 9324047
e-mail: sales@dampertechnology.com
web: www.dampertechnology.com

Technical information at:

www.orbinox.com



ORBINOX reserves the right to change specifications without notice.

09/2014